

Air Hoists & Air Balancers

ENDO Series





CONDUCTIX
wampfler

Contents

END0 at a glance	3
Air Hoist Features and Benefits	4
Air Hoist Specification Data Sheets, Warnings and Guidelines	5
Wire Rope Hoists - General Features	6
EHW-60	7
EHW-120	7
EHW-60R	8
EHW-120R	8
AH250R	9
Chain Hoists - General Features	10
AT-60K.....	11
AT125K.....	11
ATC-60K	12
ATC-125K	12
EHL-025TS.....	13
EHL-05TS.....	13
EHL-1TS.....	13
EHL-3TS.....	13
EHL-1TW.....	14
EHL-2TW.....	14
EHL-6TW.....	14
Air Powered Trolleys - Series MTH	14-17
Accessories and Spare Parts	18
PFT Manual Trolleys for I-Beams	18
Overload Protector	18
Air Balancer - General Information	19
Safety Load Restraint Features	19
EHB Series Air Balancer	20-21
EHB-CR Double Load Chain	22-23
EHB-85D Series Air Balancer w/ inertia braking	24
Series ABC - Fully Automatic Air Balancer	25
Accessories & Options	26
Hoist Modules.....	26
Trolley	26
Hook Set	26
Other Conductix-Wampfler Products	27
Conductix-Wampfler Contact Information	28

ENDO at a glance

Wire Rope Hoists	Model	Max. Capacity lb (kg)	Max. Lift Height ft (m)
	EHW-60	132 (60)	6.6 (1.9)
	EHW-120	264 (120)	6.6 (1.9)
	EHW-60R	132 (60)	6.6 (1.9)
	EHW-120R	264.6 (120)	6.6 (1.9)
	AH250R	551 (250)	8.2 (2.5)
Chain Hoists	Model	Max. Capacity	Max. Lift Height ft (m)
	AT-60K	132 (60)	9.8 (3.0)
	AT-125K	275 (125)	9.8 (3.0)
	ATC-60	132 (60)	6.65 (2.0)
	ATC-125	275 (125)	6.65 (2.0)
	EHL-025TS	551 (250)	9.8 (3.0)
	EHL-05TS	1102 (500)	9.8 (3.0)
	EHL-1TS	2204 (1000)	9.8 (3.0)
	EHL-3TS	6613 (3000)	9.8 (3.0)
	EHL-1TW	2204 (1000)	9.8 (3.0)
	EHL-2TW	4409 (2000)	9.8 (3.0)
	EHL-6TW	13227 (6000)	9.8 (3.0)
Air Balancers	Model	Max. Capacity	Max. Lift Height ft (m)
	EHB-50	121.3 (55)	6.2 (1.9)
	EHB-85	198.4 (90)	6.2 (1.9)
	EHB-130	308.6 (140)	6.2 (1.9)
	EHB-85D	198.4 (90)	6.2 (1.9)
	EHB-50ABC	88.2 (40.0)	6.2 (1.9)
	EHB-85ABC	132.3 (60.0)	6.2 (1.9)
	EHB-130ABC	187.4 (85.0)	6.2 (1.9)

Conductix-Wampfler proudly offers the **ENDO Series** of high-efficiency air hoists and air balancers. Prior to the merger between Conductix and Wampfler, and since 1979, Wampfler USA was the exclusive USA distributor of quality ENDO products in the USA. This partnership now continues with the combined strength of ENDO and Conductix-Wampfler sales organization.

ENDO products are built at their ISO 9001:2000 certified factory in Niigata, Japan. Their stringent quality systems assure that you will get the right air hoist or air balancer... every time!

Conductix-Wampfler in the USA, headquartered in Omaha, NE, started as "Industrial Electric Reels" (IER) and later merged with "Insul-8 Corporation". In 1991, the Insul-8 plant was moved to Harlan, IA. In 2006, the company became part of the Delachaux Group since 1975, was renamed "Conductix". With the merger of Conductix and Wampfler in 2007, **Conductix-Wampfler** is the world leader in design and manufacture of high-performance energy and data transmission system for industrial applications and the proud representative of ENDO Air Hoists and Balancers.



ENDO High-Efficiency Air Hoists

More efficient solution than electric hoists

Air hoists are ideal for applications where:

- **Accurate work placement is needed:** Air hoists allow for continuously variable speed control for precise positioning.
- **Continuous operation is needed:** Air hoists are self-cooling during operation; the “run-time” and “number of starts” are unlimited.
- **A delicate load must be lifted:** Continuously variable air speed controls eliminate rough stops and starts.
- **The work area contains hazardous fumes:** Air hoists reduce the chance of electrical arcing hazards from an electric motor.

When selecting air hoists:

- Size the air hoist based on load and lifting length requirements. Please refer to the Specification Data Sheet on Pg. 5.

ENDO Air Hoists Features

- **Easy handling:** Due to the small, compact, but powerful hoist bodies.
- **Improved working efficiency:** Especially with repeat lift jobs, since ENDO hoists are high speed and don't overheat.
- **Ability to do precise work:** Such as fixture setting, due to smooth continuous operation. ENDO air hoists use continuously variable speed controls. Operation depends on the degree of force used on the push buttons or the amount of pull applied to the control rope. This controls the amount of air allowed into the hoist motor.
- **Easy installation:** The air hoist is ready to work as soon as you connect the air hose. No adjustment necessary. Always make sure that you have air flowing before you connect the hoist to avoid any problems with the control valve. (Check operations manual for filter, lubrication, and installation requirements.)
- **Indoor use only:** Ambient temperature range from 14°F to 122°F (-10°C to 50°C).



Model EHW
Wire Rope Hoist



Model EHL
Chain Hoist



Model MTH
Air Trolley System

Specification Data Sheet

To choose the air hoist that will perform properly, please fill in the following information to obtain a quote.

Request Date: _____	Sales Person: _____
Company: _____	Contact: _____
_____	Title: _____
_____	Telephone: _____
_____	Fax: _____
_____	E-Mail: _____

General Operating Conditions

Environment: Indoor Outdoor

Temperature range (°F) _____ Min _____ Max

Humidity (%) _____

Corrosives? (List) _____

Clean Room? No Yes If Yes, type? _____

Food Prep Area? No Yes If Yes, type? _____

Air Hoist Specifications

General Application _____

Type of items to be lifted _____

Maximum weight of items to be lifted _____

Required maximum lift height range _____

Average lifts (per day) _____

AIR HOIST SAFETY WARNINGS - PLEASE READ

- Do not operate the hoist before reading the instruction manual
- Do not lift or transport personnel with any equipment shown or described in this catalog.
- Instruct all employees working around cranes or hoists, or assisting in hooking/arranging a load, not to stand under the load.
- Never operate a damaged or malfunctioning hoist or a hoist with a twisted or damaged rope or chain.
- Check all applicable industry, trade association, federal, state and local regulations.
- Be sure that supporting structures and load-attaching devices used to suspend the hoist are adequate to handle the rated load plus the weight of the hoist.
- Before lifting, make sure that the load is correctly seated on the load hook and centered with the hoist.
- Never overload any hoisting equipment. Read all operating instructions and warnings carefully.
- Do not operate the hoist without lubricator and filter.

Phone: 800 326 2899 | 800 521 4888 | 859-814-2100

Fax: 858-814-2110 | 800-780-8329



Wire Rope Series

ENDO Wire Rope Air Hoist Features

- **Reduction Gears:** Small, light, heat-treated planetary gears can accommodate large speed reductions.
- **Control Valve:** Engineered with spring-return spool valves, two positions and three ports. The valve works by controlling the lever switch connected to the spool.
- **Crane Brake System:** Integrated into the wire rope hoist and connected using the control valve coupled to the speed reduction mechanism in the motor.
- **Reverse Winding Protection:** Incorporated as a safety feature to shut down the motor if the wire rope exceeds the 6.33 ft (1.9 m) stroke.

Basic Styles of Wire Rope Hoists



EHW-60 EHW-120
(body and hook moving type)



EHW-60R EHW-120R
(hook moving type with pendant control)



AH-250R
(hook moving type with pendant control)

Series EHW Wire Rope Air Hoist

The Series EHW air powered wire rope hoist is offered with pendant-style control. Air power provides the benefits of more precise placement of objects, and no down time need to cool the hoist, as would be the case with an electric hoist. These hoists are ready for operations upon receipt. Simply connect the air lines supplying lubricated air.

- Ready to use, just connect lubricated air supply.
- Compact and lightweight.
- Conical brake and rotary vane air motor design.
- Wire rope diameter: 0.125" (3.18 mm)
- Lift Height: 6.6 feet (1.9 meters)



Part No.	Rated Load		Air Pressure		Lifting Speed		Air Consumption		Air Inlet in.	Weight	
	lb	(kg)	bar	(PSI)	ft/min	(m/min)	cf/min	(m3/min)		lb	(kg)
EHW-60	132	60	4	58.0	60.7	18.5	19.4	0.55	3/8" NPT	20.3	9.2
			5	72.5	73.8	22.5	24.7	0.70			
			6	87.0	85.3	26.0	31.1	0.88			
EHW-120	264	120	4	58.0	36.6	11.0	20.8	0.59	3/8" NPT	20.7	9.4
			5	72.5	44.6	13.5	26.5	0.75			
			6	87.0	52.5	16.0	32.8	0.93			

Spare Parts	
Cable	LHP000064
Wire guide set	LHP000150

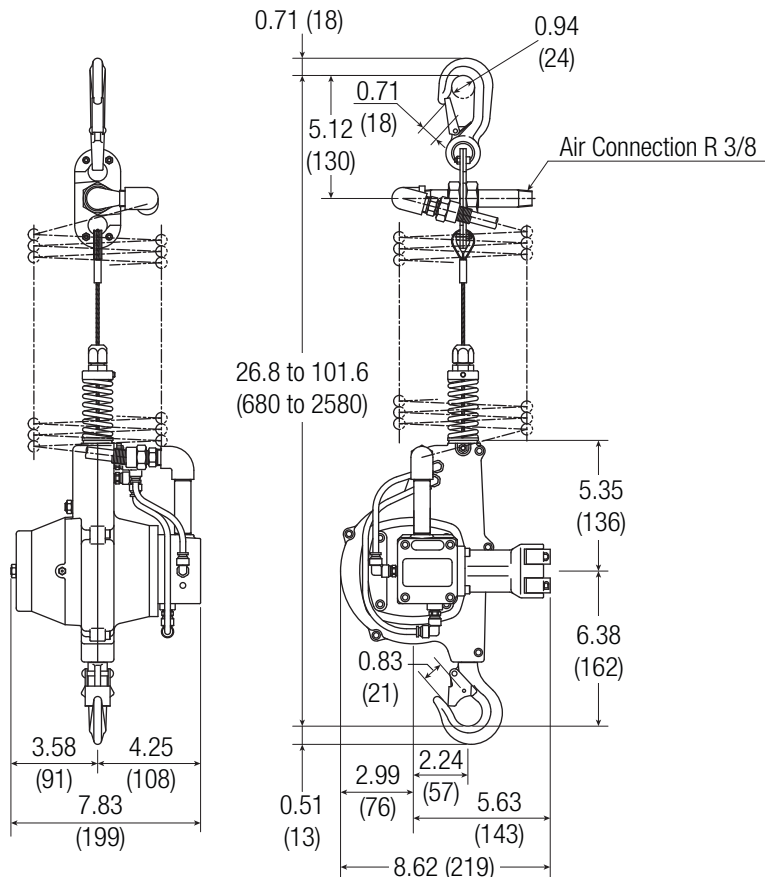

Series EHW-R Wire Rope Hoist

The Series EHW air powered wire rope hoist is offered with pendant-style control. Air power provides the benefits of more precise placement of objects, and no down time need to cool the hoist, as would be the case with an electric hoist. These hoists are ready for operation upon receipt. Simply connect the air lines supplying lubricated air.

- Ready to use, just connect lubricated air supply.
- Compact and lightweight.
- Conical brake and rotary vane air motor design.
- Wire rope diameter: 0.125" (3.18mm)
- Lift Height: 6.6 feet (1.9 meters)



Part No.	Rated Load		Air Pressure		Lifting Speed		Air Consumption		Air Inlet in.	Weight	
	lb	(kg)	bar	(PSI)	ft/min	(m/min)	cf/min	(m3/min)		lb	(kg)
EHW-60R	132	60	4	58.0	60.7	18.5	19.4	0.55	3/8" NPT	20.9	9.2
			5	72.5	73.8	22.5	24.7	0.70			
			6	87.0	85.3	26.0	31.1	0.88			
EHW-120R	264	120	4	58.0	36.6	11.0	20.8	0.59	3/8" NPT	21.4	9.57
			5	72.5	44.6	13.5	26.5	0.75			
			6	87.0	52.5	16.0	32.8	0.93			

Optional Speed Control



Standard control is shown at the left. To order optional control with red emergency stop button - shown right - add "-5" to the part number.

Spare Parts

Cable	LHP000064
Wire guide set	LHP000150

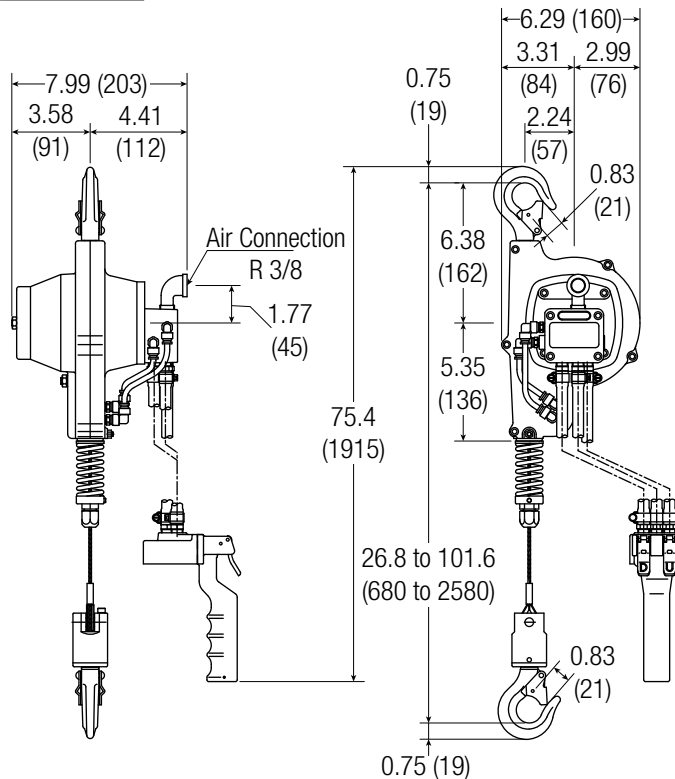

Chain Series

ENDO Chain Air Hoist Features

- **Ideal for frequent hoist operation:** No heat build-up, making it possible to operate the hoist continuously without cool-down period.
- **High Load capacities:** Available from 132 lb (60 kg) to 6 tons with a variety of options.
- **Handles longer lift heights:** Approximately 57% longer lift height than EHW-60/EHW-120 or EHW-60R/EHW-120R wire rope hoists. Many models can accept a longer chain with an optional larger basket.
- More headroom with the AT-60K or AT-125K: Smaller, more compact than the EHW rope series.
- **Safety Features:** AT-60K and AT-125K have factory installed life and lower limit switch. Selected EHL models offer optional overhead protection.
- **Chain Life:** Chains last longer than wire rope. For example, the AT-60K or AT-125K will run 70,000 cycles before the chain needs to be replaced, versus 1500 cycles for wire rope.
- **All ENDO chains** are surface hardened load chain with T, Grade 8



Basic Structure of the ENDO Chain Air Hoists

The ENDO vane motor consists of a set of seven vanes incorporated into the rotor. The vanes cause the rotor to rotate when exposed to air pressure thus enabling the motor to raise and lower the load.

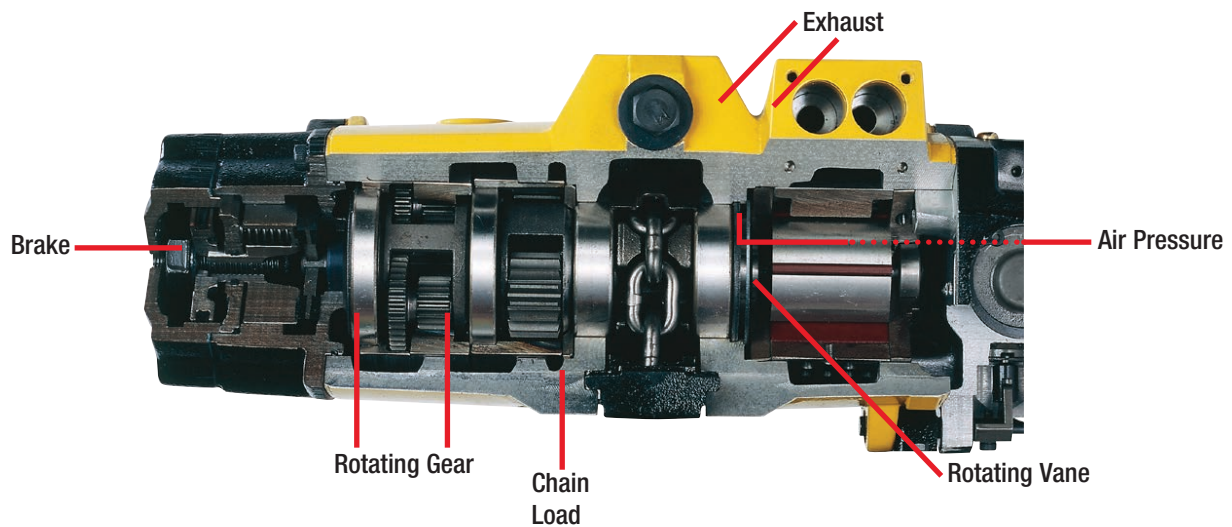

Series AT Chain Air Hoist

The compact, light-weight AT-60K and AT-125K hoists combine the high speeds of wire rope hoists (up to 77 ft./minute) with the high durability of chain hoists. These hoists are ready for operation right out of the box; just connect lubricated air. Can be mounted on air trolley or manual trolley - by request.

- Conical brake and rotary vane motor design
- Pendant control for precise variable lifting and lowering speed
- Low headroom - approximately 14 inches (355.6 mm)
- Chain size: 4 x 12 mm, 11 links per 132 mm section of chain
- Lift Height: 9.8 feet (3 meters). Chain extension available.



Part No.	Rated Load		Air Pressure		Lifting Speed		Air Consumption		Air Inlet in.	Weight	
	lb	(kg)	bar	(PSI)	ft/min	(m/min)	cf/min	(m3/min)		lb	(kg)
AT-60K	132	60	4	58.0	54.1	16.5	18	0.52	3/8" NPT	27	12.3
			5	72.5	65.6	20.0	23	0.67			
			6	87.0	77.1	23.5	30	0.85			
AT-125K	275	125	4	58.0	32.8	10.0	19	0.55	3/8" NPT	28	12.5
			5	72.5	39.3	12.0	25	0.71			
			6	87.0	47.6	14.5	31	0.90			

Optional Speed Control



Standard control is shown at the left. To order optional control with red emergency stop button - shown right - add "-5" to the part number.

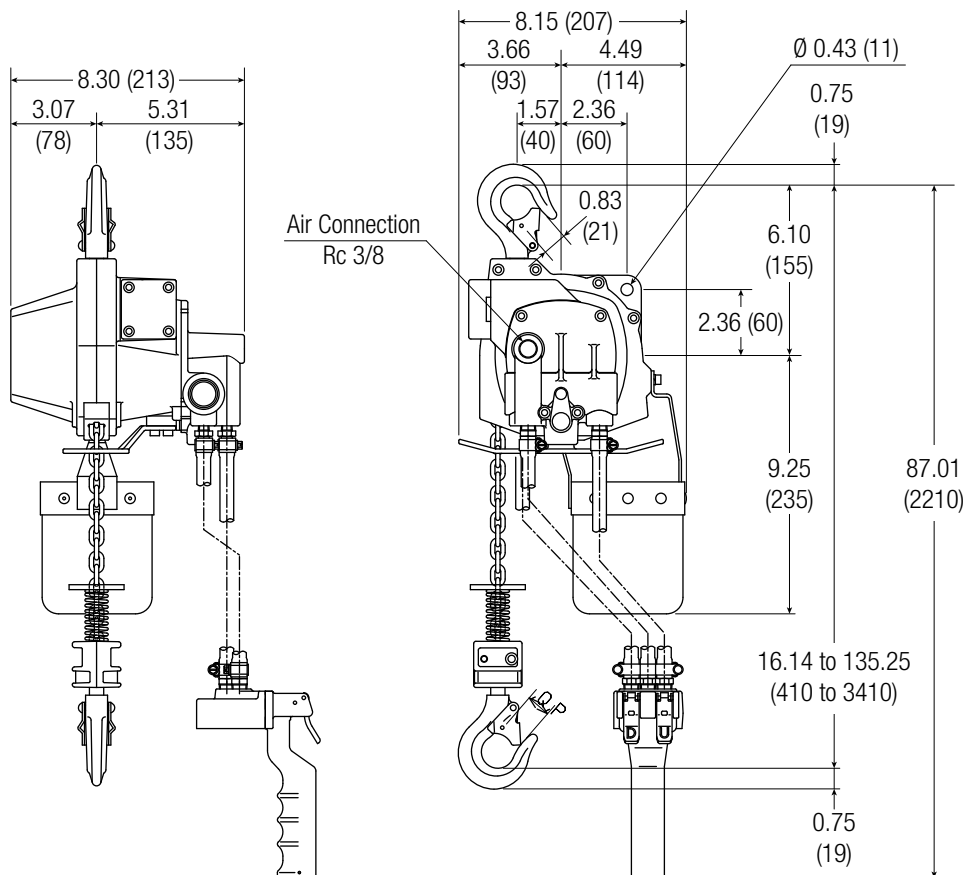

Series ATC Chain Air Hoist

The Series ATC Air Hoist features direct-controlled operation and is ready to use. Just connect lubricated air supply. Provides precise variable lifting and lowering speed. Can be mounted on air trolley or manual trolley- by request.

- Manipulator-style pendant control for precise variable lifting and lowering speed
- Air inlet is 3/8" NPT
- Chain size: 4 x 12 mm, 11 links per 132 mm section of chain
- Lift Height: 6.65 ft (2 meters)



Part No.	Rated Load		Air Pressure		Lifting Speed		Air Consumption		Air Inlet	Weight	
	lb	(kg)	bar	(PSI)	ft/min	(m/min)	cf/min	(m3/min)		lb	(kg)
ATC-60K	132	60	4	58.0	45.9	14.0	18	0.52	3/8" NPT	31.5	14.3
			5	72.5	55.8	17.0	23	0.67			
			6	87.0	65.6	20.0	30	0.85			
ATC-125K	275	125	4	58.0	21.3	6.5	19	0.55	3/8" NPT	32	14.5
			5	72.5	34.5	10.5	25	0.71			
			6	87.0	39.4	12.0	31	0.90			

Optional Speed Control



Standard control is shown at the left. To order optional control with red emergency stop button - shown right - add "-5" to the part number.

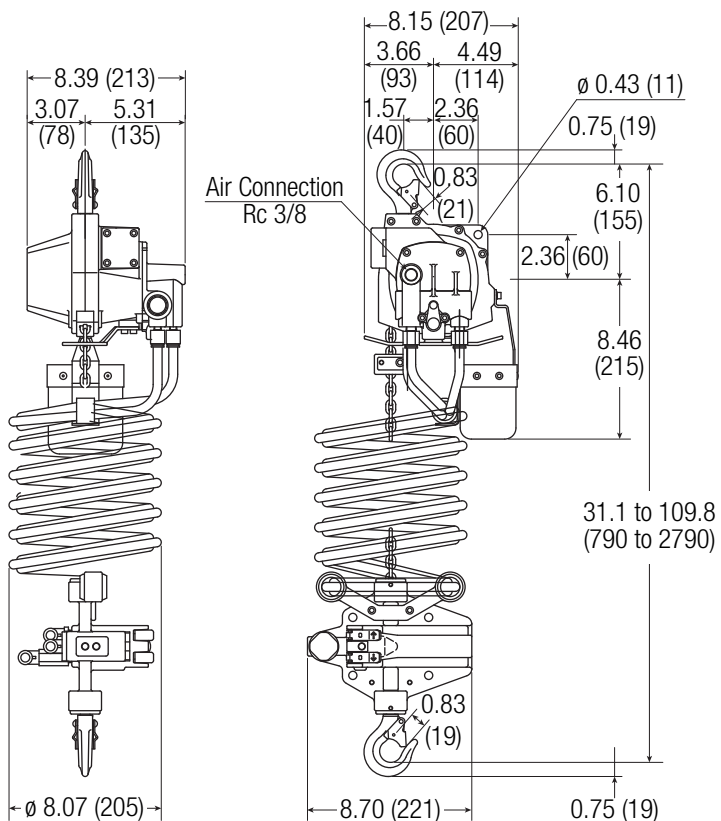

Series EHL (Type TS) Chain Air Hoist

The compact, light weight Model EHL Type TS air powered chain hoist can handle weight ranges from 1/4 to 4 metric tons. These hoists come standard with a pull chain control and 3 meters of lift. Also available with pendant control, see below. Lifts can be changed from 3 meters to as little as 1 meter or as large as 20 meters with optional longer chain. For dimensions, see the bottom of page 13.

- Automatic friction brake is adjustment-free and durable.
- Can be mounted on air trolley - See pages 14-15
- Overload protection available - See page 16 (EHL-05TS and larger)
- Std Lift Height: 9.8 feet (3 meters). Other heights available.

- Chain size: **EHL-025TS/05TS:** 6 x 19 mm, 5 links per 95.7 mm section of chain
- Chain size: **EHL-1TS:** 7 x 21mm, 5 links per 106 mm section of chain
- Chain size: **EHL-3TS:** 13 x 39 mm, 5 links per 191 mm section of chain



EHL-1TS

Part No.	Rated Load		Air Pressure		Lifting Speed		Air Consumption		Air Inlet	Weight	
	lb	(kg)	bar	(PSI)	ft/min	(m/min)	cf/min	(m3/min)	in.	lb	(kg)
EHL-025TS	551	(250)	4	58.0	39.6	12.0	31.8	0.90	1/2" NPT	41	18
			5	72.5	52.5	16.0	45.9	1.30			
			6	87.0	59.1	18.0	56.5	1.60			
EHL-05TS	1,102	(500)	4	58.0	24.6	7.5	33.5	0.95	1/2" NPT	41	18
			5	72.5	29.5	9.0	45.9	1.30			
			6	87.0	34.4	10.5	58.3	1.65			
EHL-1TS	2,204	(1,000)	4	58.0	13.1	4.0	35.3	1.0	1/2" NPT	75	34
			5	72.5	17.1	5.2	49.4	1.4			
			6	87.0	19.7	6.0	63.6	1.80			
EHL-3TS	6,613	(3000)	4	58.0	6.6	2.0	53.0	1.75	3/4" NPT	165	75
			5	72.5	8.5	2.6	87.3	2.47			
			6	87.0	9.9	3.0	110.9	3.14			

Standard Pull Rope Control

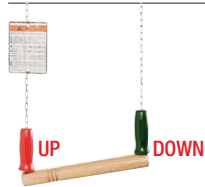

Speed depends on how hard the rope is pulled. For optional pendant control, see below.

Optional Pendant Controls

Optional pendant controls are available to replace the standard pull rope control on "EHL" hoists only. Available without or with an emergency safety switch. Maximum pendant hose is 19.7 ft (6 m). Hose must be less than 26.25 ft (8 m) long. (See Page 17)



PCS-1 & PCS-2 PCS-2BV1 & PCS-2BV2

Hoist Part No.	Pendant Part No.	Pendant Part No. w/Emergency Switch	Weight	
			Lb	Kg
EHL-025TS	PCS-1	PCS-1B	5.1	2.3
EHL-05TS	PCS-1	PCS-1B	5.1	2.3
EHL-1TW	PCS-1	PCS-1B	5.1	2.3
EHL-1TS	PCS-2	PCS-2B	6.0	2.7
EHL-2TW	PCS-2	PCS-2B	6.0	2.7
EHL-3TS	PCS-2	PCS-2B	6.0	2.7
EHL-6TW	PCS-2	PCS-2B	6.0	2.7

Series EHL (Type TW) Chain Air Hoist

The compact light weight model EHL, Type TW, air powered chain hoist can handle weight ranges from 1 to 6 metric tons. These hoists come standard with a pull chain control and 3 meters of lift. Also available with pendant control, see pg 13. Lifts can be changed from 3 meters to as little as 1 meter or as large as 20 meters with optional longer chain. For dimensions, see bottom of this page.

- Automatic friction brake is adjustment-free and durable.
- Can be mounted on air trolley - See pages 15-18
- Overload protection available - See page 18 (EHL-05TS and larger)
- Std Lift Height: 9.8 feet (3 meters). Other heights available.
- Chain size: **EHL-1TW**: 6 x 19 mm, 5 links per 95.7 mm section of chain
- Chain size: **EHL-2TW**: 7 x 21mm, 5 links per 106 mm section of chain
- Chain size: **EHL-6TW**: 13 x 39 mm, 5 links per 191 mm section of chain



EHL-6TW

Part No.	Rated Load		Air Pressure		Lifting Speed		Air Consumption		Air Inlet in.	Weight	
	lb	(kg)	bar	(PSI)	ft/min	(m/min)	cf/min	(m3/min)		lb	(kg)
EHL-1TW	2,204	(1,000)	4	58.0	12.1	3.7	33.5	0.95	1/2" NPT	58	24
			5	72.5	14.8	4.5	45.9	1.30			
			6	87.0	17.1	5.2	58.3	1.65			
EHL-2TW	4,409	(2,000)	4	58.0	6.6	2.0	35.3	1.00	1/2" NPT	92	42
			5	72.5	8.5	2.6	49.4	1.40			
			6	87.0	9.9	3.0	63.6	1.80			
EHL-6TW	13,227	(6,000)	4	58.0	3.3	1.0	53.0	1.75	3/4" NPT	211	96
			5	72.5	4.3	1.3	87.3	2.47			
			6	87.0	4.9	1.5	110.9	3.14			

Standard Pull Rope Control

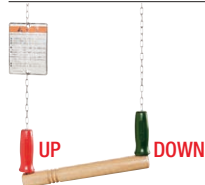

Speed depends on how hard the rope is pulled. For optional pendant control, see below.

Model EHL Dimensions

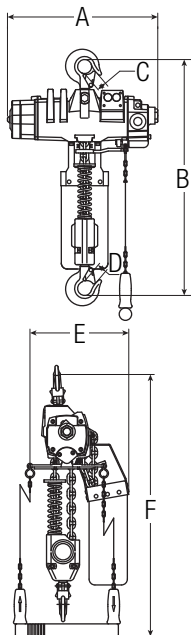

Part No.	A - in. (mm)	B - in. (mm)	C - in. (mm)	D - in. (mm)	E - in. (mm)	F - in. (mm)
EHL-025TS	13.62 (345)	14.76 to 132.87 (374 to 3374)	.98 (25)	.98 (25)	11.42 (290)	94 (2387)
EHL-05TS	13.62 (345)	14.76 to 132.87 (374 to 3374)	.98 (25)	.98 (25)	11.42 (290)	94 (2387)
EHL-1TS	19.17 (486)	18.78 to 136.89 (477 to 3477)	1.26 (32)	1.14 (29)	11.22 (284)	97 (2463)
EHL-3TS	22.68 (576)	22.91 to 141.02 (581 to 3581)	1.93 (32)	1.42 (36)	13.70 (347)	104 (2641)
EHL-1TW	13.62 (345)	18.90 to 137.00 (480 to 3479)	1.14 (29)	1.14 (29)	11.42 (290)	95 (2413)
EHL-2TW	19.17 (486)	21.10 to 139.21 (535 to 3535)	1.26 (32)	1.26 (32)	11.22 (284)	97 (2463)
EHL-6TW	22.68 (576)	30.24 to 148.35 (768 to 3768)	1.93 (32)	1.93 (32)	13.70 (347)	104 (2641)

Series MTH Air Motor Trolley

The ENDO air motor trolley is used to propel the EHL air hoist along an I-beam. These trolleys are ideal for hazardous locations, such as a chemical factory, since the power source is not electricity, but compressed air. The unit uses stepless speed controls for precise operation.

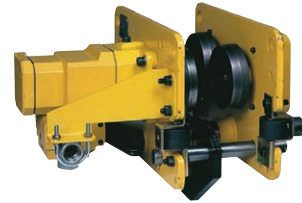

Close up of Trolley Wheel Assembly

MTH-6.3T w/EHL-3TS hoist and optional PCS-42 4-button control

For Hoist Model	Use Air Motor Trolley Model
EHL-025TS	MTH-1T-5
EHL-05TS	MTH-1T-5
EHL-098TW	MTH-1T-5
EHL-1TW	MTH-1T-5
EHL-1TS	MTH-2T-5
EHL-2TW	MTH-2T-5
EHL-3TS	MTH-6.3T
EHL-6TW	MTH-6.3T

Operational Capacities and Data

Part No.	Capacity		Air Pressure		Traveling Speed		Air Consumption		Air Inlet in.	Weight	
	lb	(kg)	bar	(PSI)	ft/min	(m/min)	cf/min	(m3/min)		lb	(kg)
MTH-1T-5	2,204	(1,000)	4	58.0	65.6	20	19.42	.55	1/2" NPT	77.16	35
			5	72.5	82.0	25	21.19	.60			
			6	87.0	91.9	28	37.08	1.05			
MTH-2T-5	4,409	(2,000)	4	58.0	52.5	16	35.31	1.00	1/2" NPT	138.9	63
			5	72.5	55.8	17	45.91	1.30			
			6	87.0	59.1	18	56.50	1.60			
MTH-6.3T	13,889	(6,300)	4	58.0	55.8	17	35.31	1.00	1/2" NPT	280	127
			5	72.5	59.1	18	45.91	1.30			
			6	87.0	62.3	19	56.50	1.60			

Pendant Switch Control Choices

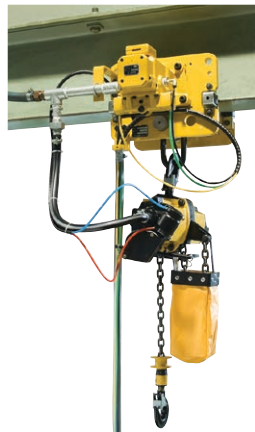

Trolley No.	Pendant Control No.	Can Control "EHL" Hoist	Safety Stop
MTH-1T-5	PCS-3	no	no
MTH-2T-5	PCS-3	no	no
MTH-6.3T	PCS-3	no	no
MTH-1T-5	PCS-41	yes	no
MTH-1T-5	PCS-41B	yes	yes
MTH-2T-5 or MTH-6.3T	PCS-42	yes	no
MTH-2T-5 or MTH-6.3T	PCS-42B	yes	yes



Series MTH Air Motor Trolley Dimensions

Part No.	Capacity		Fits Beam Width In. (mm)	Min. Curve Radius In. (mm)
	lb	(kg)		
MTH-1T-5	2,204	(1,000)	2.95 (75)	137.8 (3500)
			3.94, 4.92 (100, 125)	31.5 (800)
MT-2T-5	4,409	(2,000)	4.93, 5.91 (125, 150)	39.4 (1000)
MTH-6.3	13,889	(6,300)	5.91, 6.89, 7.48 (150, 175, 190)	98.4 (2500)



MTH-1T5
w/PCS3 Traverse
Switch

4 Button Pendant
Switch is Available
- See Pg. 15.

MTH-1T5

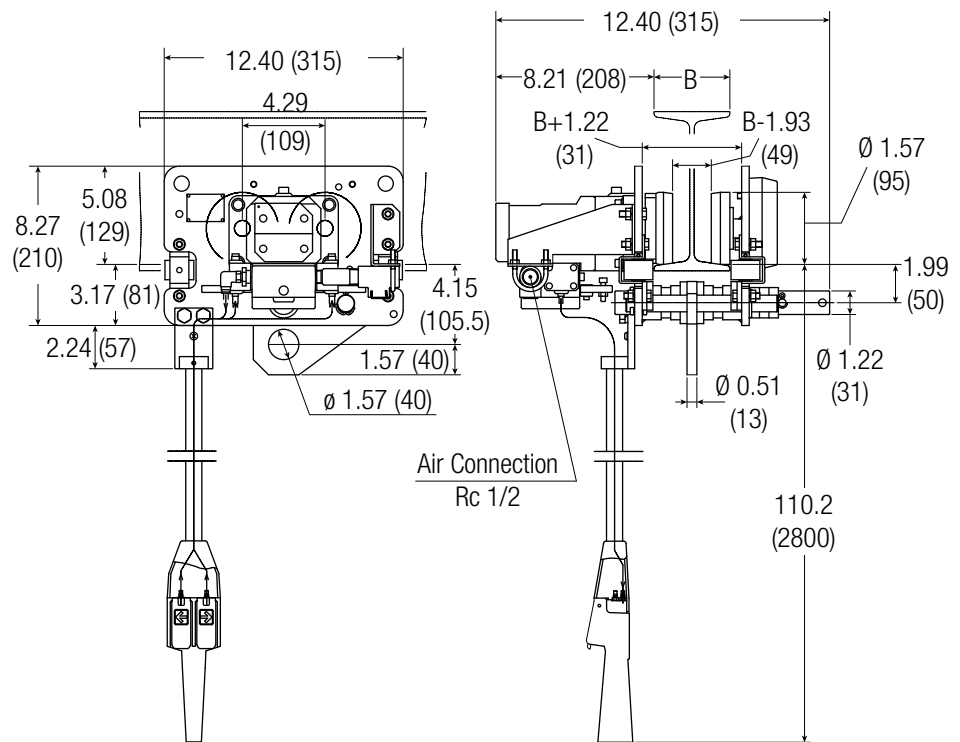

Series MTH Air Motor Trolley Dimensions



MTH-2T-5

MTH-2T5

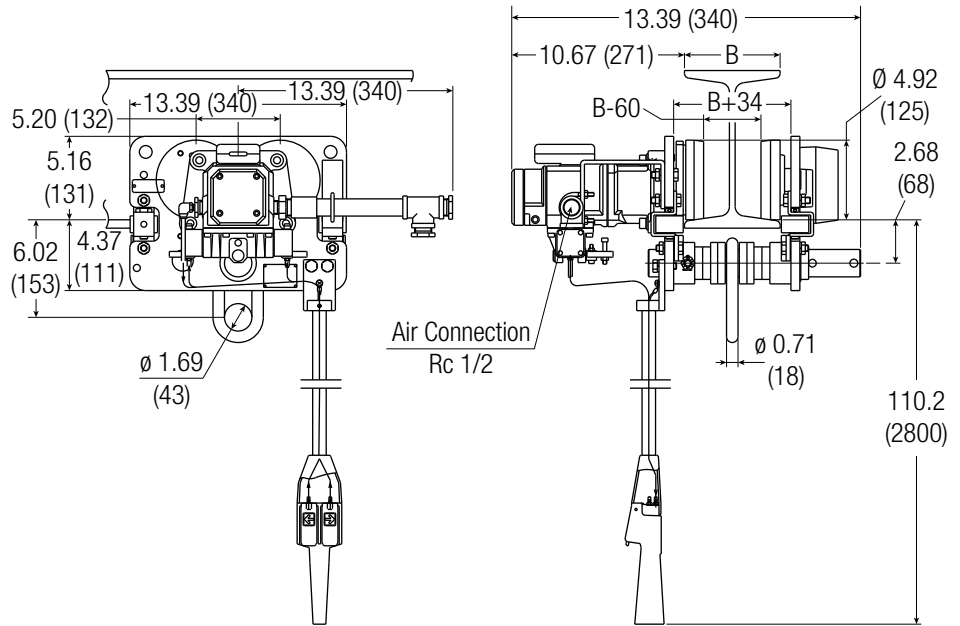

MTH-6.3T

MTH-6.3T

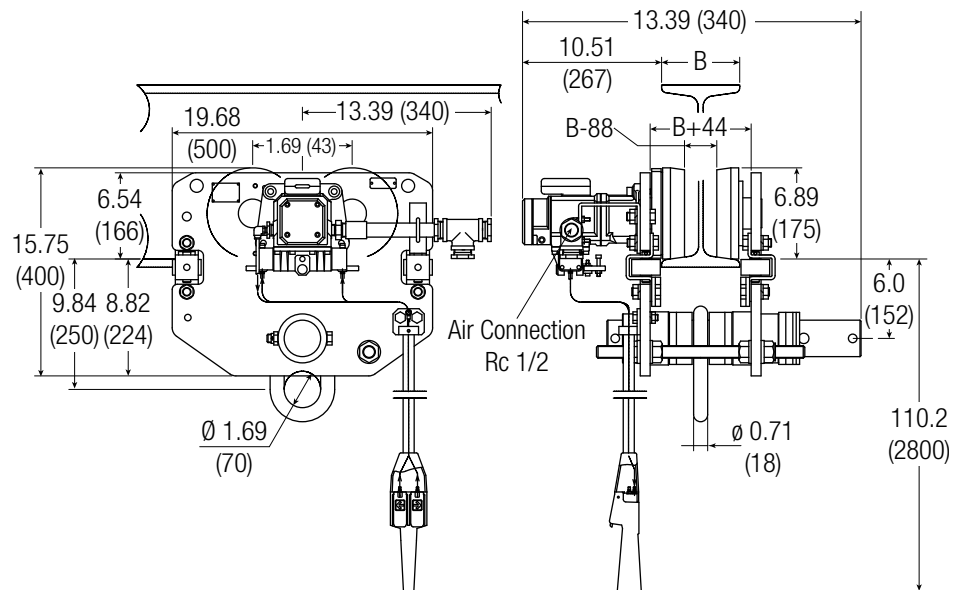

Accessories & Spare Parts

Series PFT Manual Trolleys for I-Beams

The Series PTF manual trolleys are used to suspend small air hoists from I-beams, railways or jib booms. Model PTF-125 and PTF-250 are easily adjustable for different size beams. In addition, the frame is designed to protect the wheels from collisions with other trolleys and can be fitted with rubber bumpers for further protection. Dimensions are available in CAT1007 balancer catalog - Pg.27



Series PTF-125

PTF-125

Part No	Capacity		Min. Curve Radius		Beam Width		Weight	
	lbs.	(kg)	In.	(mm)	in	(mm)	lbs	(kg)
PFT-125	276	(125)	24	(600)	2.0 / 2.95	(50 / 75)	3.50	(1.60)
PFT-250	551	(250)	35	(900)	2.95 / 3.93 / 4.92	(75 / 100 / 125)	9.25	(4.20)

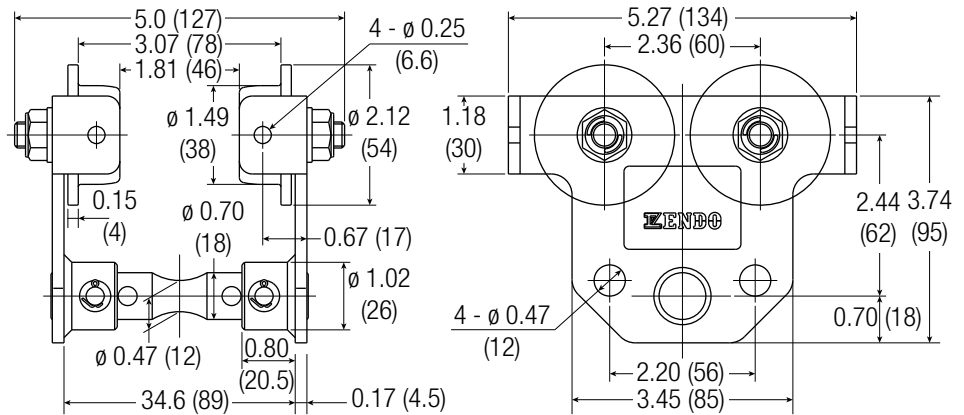

PTF-250

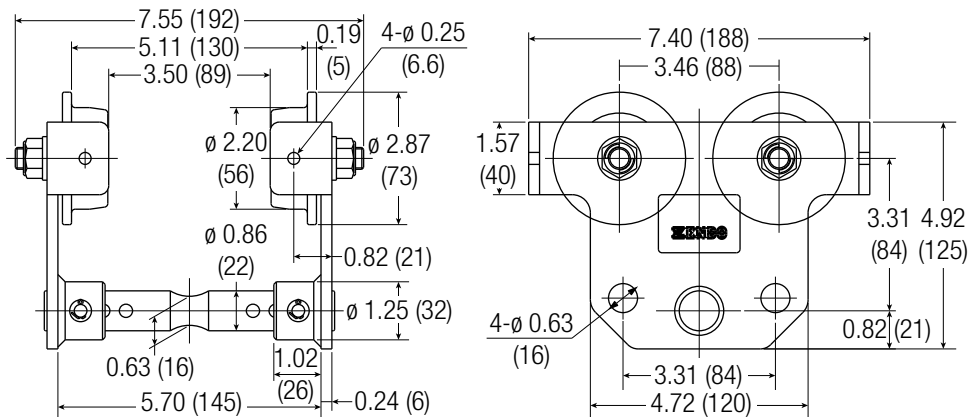

Overload Protector

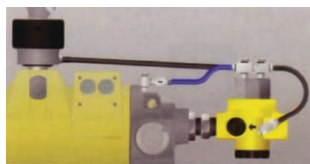

Part No.	Use on Hoist Model	Weight	
		lbs.	(kg)
OP-05TS	EHL-05TS	4.41	(2.0)
OP-1TW	EHL-1TW	4.85	(2.2)
OP-1TS	EHL-1TS	13.67	(6.2)
OP-2TW	EHL-2TW	13.67	(6.2)
OP-3TS	EHL-3TS	48.50	(22.0)
OP-6TW	EHL-6TW	48.50	(22.0)

ENDO Air Balancers - General Information

ENDO products are built at their ISO 9001:2008 certified factory in Niigita, Japan. Their stringent quality systems assure that you will get the right balancer or hoist every time!

Conductix-Wampfler is the world leader in the design and manufacture of high-performance spring-driven and air powered devices for industrial applications and proud representative of ENDO balancers and air hoists.

The Air Balancer Advantage!

Air Balancers provide weight lifting capabilities, but much more accurate positioning versus an air hoist. Air balancers are used to assembly lines where precise load positioning is required.



Safety Load Restraint Features

Condition	Will Hoist Hold the Load?				
	Hoist Module Style:				
	MS	MS-A	MS-AG	ABC-5P-B	ABC-5G-B
If air supply is shut off?	Yes	Yes	Yes	Yes	Yes
If "up-side" control hose is cut or damaged?	Yes	Yes	Yes	Yes	Yes
If "down-side" control hose is cut or damaged?	No	Yes	Yes	Yes	Yes



EHB Series Air Balancer



EHB-85 Body
With MS-A Hoist Module

High quality, but economically priced. The “EHB” series operates with compressed air to provide both hoist and balancing functions.

- The load on the hook can be balanced at “zero gravity”
- The unit operates with very low noise
- The 0.187 (4.76 mm) dia wire rope provides long life and less maintenance cost
- The non-electric air drive is ideal for facilities that require “hazardous duty” (explosion-proof) equipment

Order Balancer Body and Hoist Module separately.

Balancer Body

Part No.	Air Pressure		Max. Lifting Capacity		Air Inlet	Stroke		Weight	
	PSI	(MPa)	lbs	(kg)		ft	(m)	lbs	(kg)
EHB-50	58.0	(0.4)	70.5	(32)	Rc 3/8	6.2	(1.9)	61.7	(28)
	72.5	(0.5)	88.2	(40)	Rc 3/8	6.2	(1.9)	61.7	(28)
	87.0	(0.6)	105.8	(48)	Rc 3/8	6.2	(1.9)	61.7	(28)
	101.5	(0.7)	121.3	(55)	Rc 3/8	6.2	(1.9)	61.7	(28)
EHB-85	58.0	(0.4)	110.2	(50)	Rc 3/8	6.2	(1.9)	63.9	(29)
	72.5	(0.5)	136.7	(62)	Rc 3/8	6.2	(1.9)	63.9	(29)
	87.0	(0.6)	165.3	(75)	Rc 3/8	6.2	(1.9)	63.9	(29)
	101.5	(0.7)	198.4	(90)	Rc 3/8	6.2	(1.9)	63.9	(29)
EHB-130	58.0	(0.4)	176.4	(80)	Rc 3/8	6.2	(1.9)	79.4	(36)
	72.5	(0.5)	220.5	(100)	Rc 3/8	6.2	(1.9)	79.4	(36)
	87.0	(0.6)	264.6	(120)	Rc 3/8	6.2	(1.9)	79.4	(36)
	101.5	(0.7)	308.6	(140)	Rc 3/8	6.2	(1.9)	79.4	(36)

EHB-50 with Hoisting Module

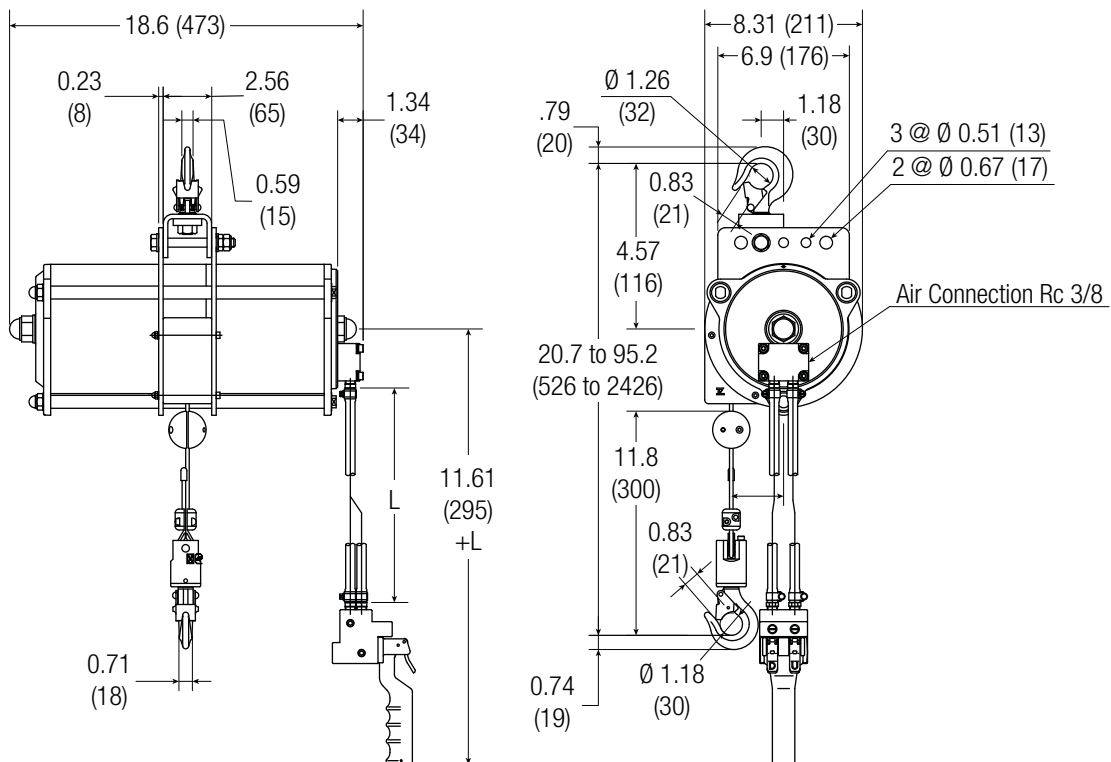

EHB Series Air Balancer Dimensional Drawings

EHB-85 with Hoisting Module

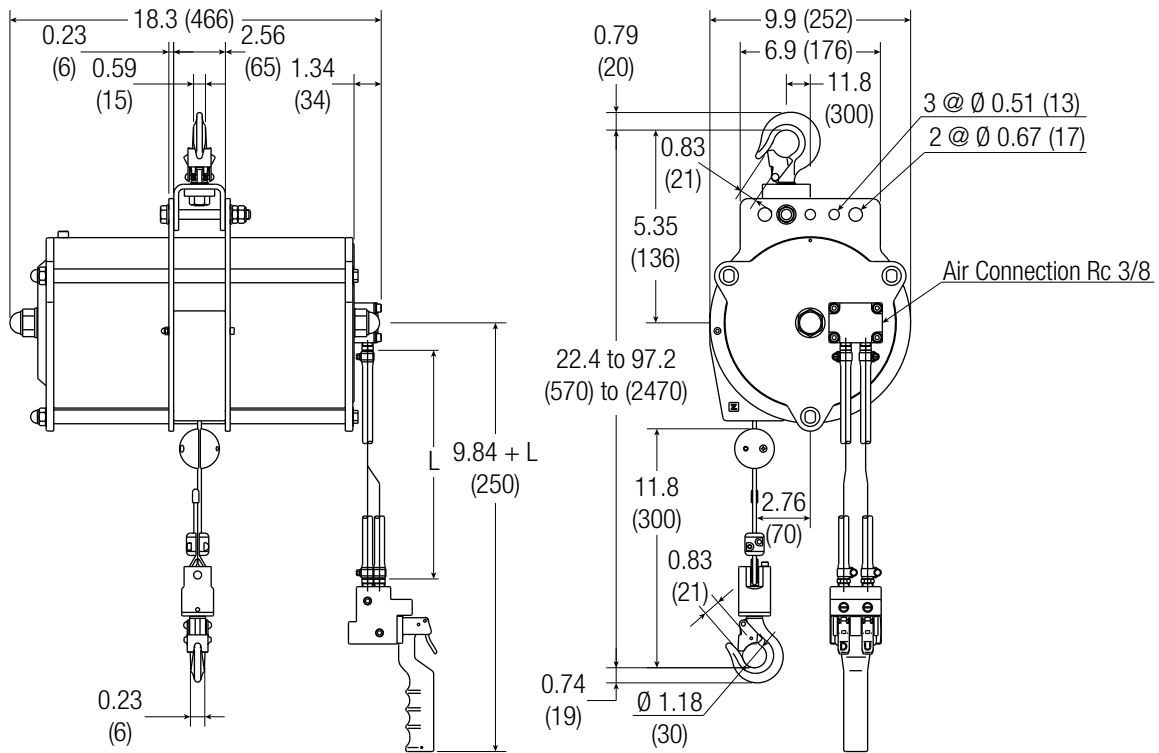

EHB-130 with Hoisting Module

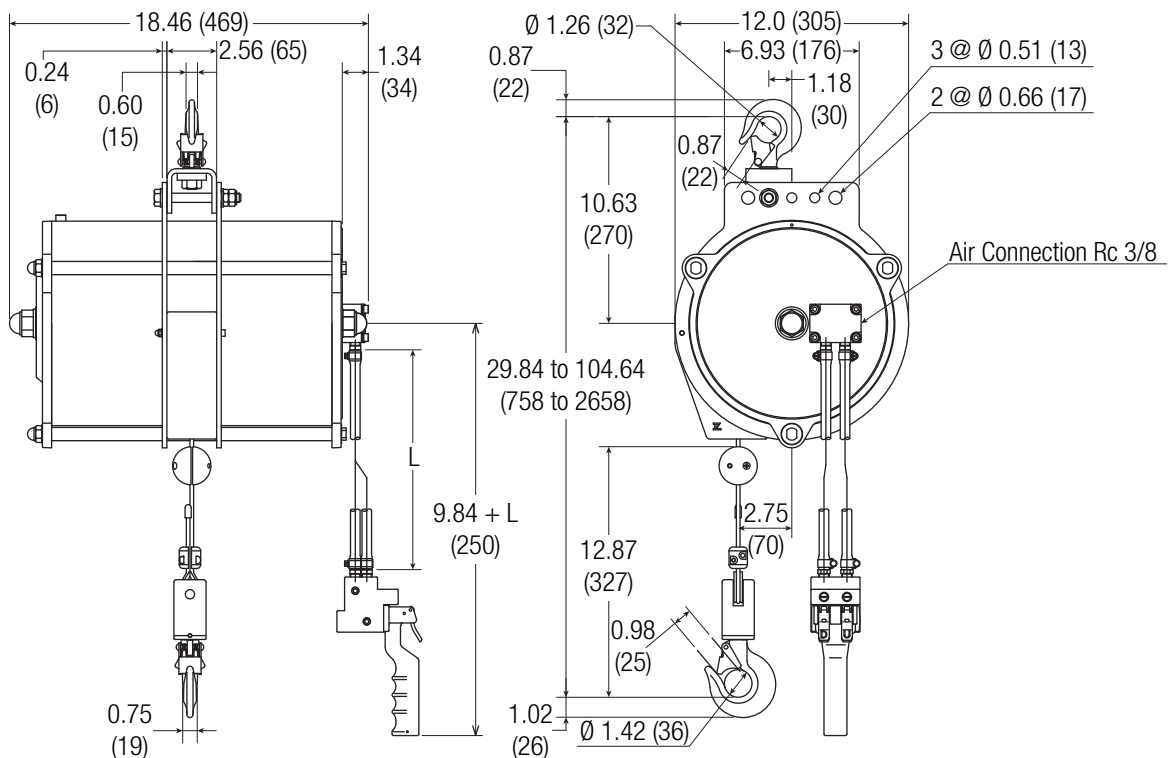

EHB - Type CR Double Load Chain



High quality, but economically priced. The “EHB” series operates with compressed air to provide both hoist and balancing functions.

- The load on the hook can be balanced at “zero gravity”
- The unit operates with very low noise
- The 0.187 (4.76 mm) dia wire rope provides long life and less maintenance cost
- The non-electric air drive is ideal for facilities that require “hazardous duty” (explosion-proof) equipment

Order Balancer Body and Hoist Module separately.

Balancer Body

Part No.	Air Pressure		Max. Lifting Capacity		Air Inlet	Stroke		Weight	
	PSI	(MPa)	lbs	(kg)		ft	(m)	lbs	(kg)
EHB-270CR	101.5	(0.7)	595	(270)	Rc 3/8	2.95	(0.9)	95	(43)
	87	(0.6)	507	(230)	Rc 3/8	2.95	(0.9)	95	(43)
	72.5	(0.5)	418	(190)	Rc 3/8	2.95	(0.9)	95	(43)
	58	(0.4)	330	(150)	Rc 3/8	2.95	(0.9)	95	(43)
EHB-450CR	87	(0.6)	992	(450)	Rc 3/8	2.78	(0.85)	110	(50)
	72.5	(0.5)	815	(370)	Rc 3/8	2.78	(0.85)	110	(50)
	58	(0.4)	639	(290)	Rc 3/8	2.78	(0.85)	110	(50)

Spare Parts

Description	Series			
	EHB-50	EHB-85	EHB-130	EHB-270
Wire Rope	LHP001904	LHP001904	LHP001904	LHP002169
Wire Guide	P2H301202	P2H301145	P2H301216	P2H301216
Hook Latch Set	LHP001674	LHP001674	LHP000213	LHP000213



EHB - Type CR Double Load Chain

EHB-270CR

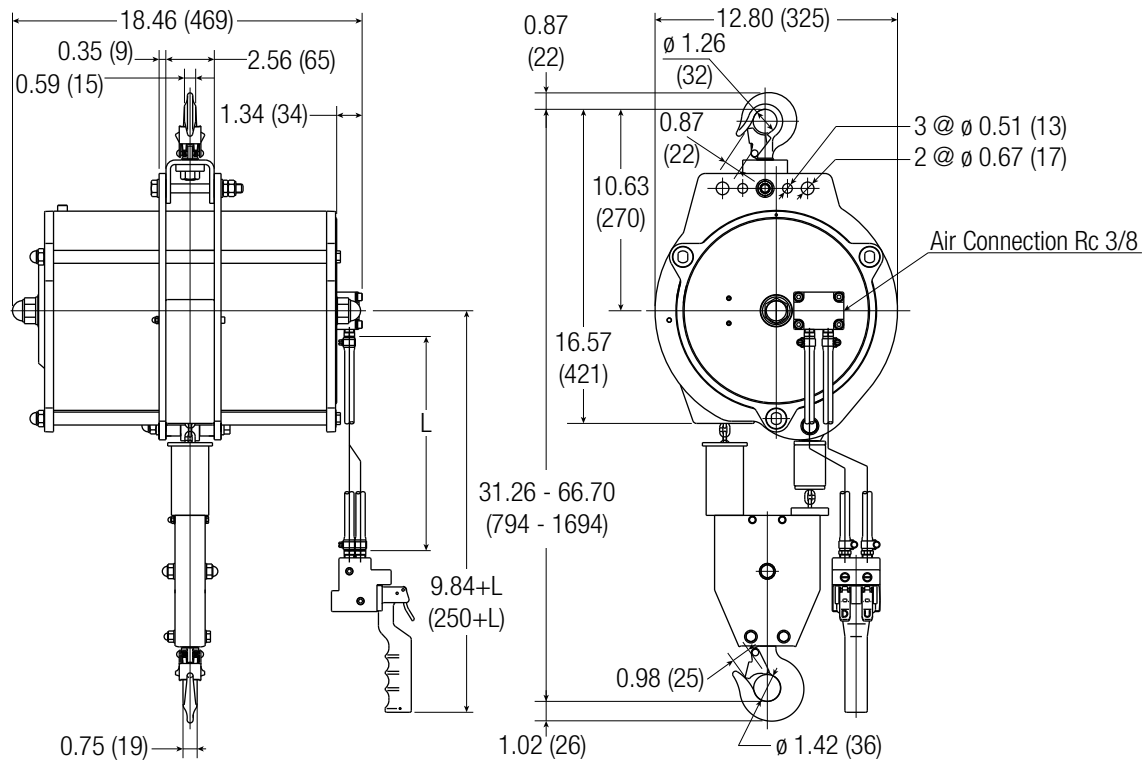

EHB-450CR

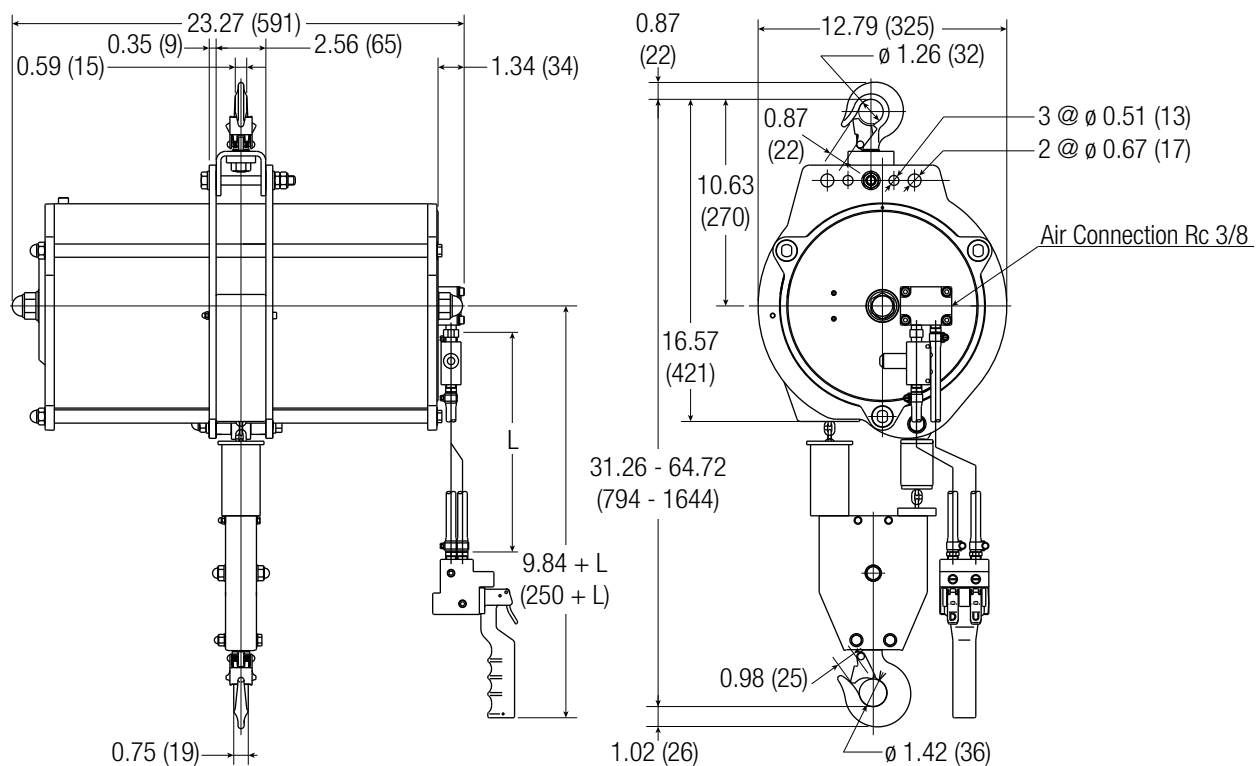

EHB-85D Series Air Balancer with Inertia Braking



Inertia Braking limits the inertia action of the load and provides comfortable operation. Patent and design registration pending.

- No down-drift of the load, even if air shuts off or the hose is cut
- Equipped with retraction control
- "Float mode" is available - which requires a bit more effort than standard mode
- Suitable for precision operation
- Cable diameter: 0.187" (4.76 mm)

Order the balancer body and hoist module separately. For optional balancer body connection methods, see bottom of page 19.

Balancer Body

Part No.	Air Pressure		Max. Lifting Capacity		Air Inlet	Stroke		Weight	
	PSI	(MPa)	lbs	(kg)		ft	(m)	lbs	(kg)
EHB-85D	58.0	(0.4)	110.2	(50)	Rc 3/8	6.23	(1.9)	83.8	(38)
	72.5	(0.5)	136.7	(62)	Rc 3/8	6.23	(1.9)	83.8	(38)
	87.0	(0.6)	165.3	(75)	Rc 3/8	6.23	(1.9)	83.8	(38)
	101.5	(0.7)	198.4	(90)	Rc 3/8	6.23	(1.9)	83.8	(38)

Hoist Module

Optional Grip with Inertia Stopper Release Switch

Part No	Unit Weight	
	lbs	(kg)
MSD	13.2	(6.0)

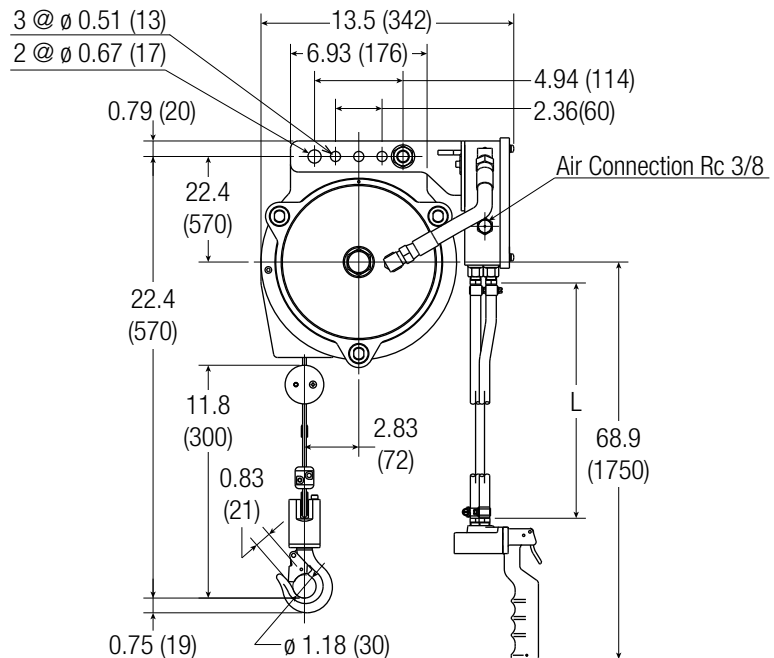
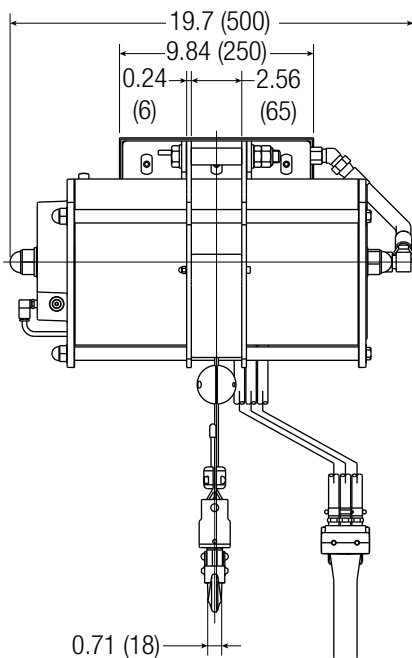

Fully Automatic Air Balancer - Type ABC

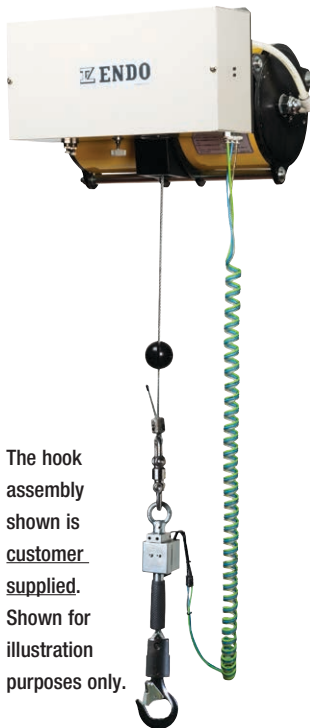

The hook assembly shown is customer supplied. Shown for illustration purposes only.

ABC-5G-B Grip Module

Ordered separately - see below

Up/down motions are controlled by the handle just above the wire rope eyelet that accepts the customer-supplied hook.

"Full Auto" Air Balancers can lift various loads in different weights without any adjustment. They provide fine balancing and positioning by hand operation or with automatic adjustment for weight.

- Fully automatic balancing feature without electricity
- Quiet Operation - low air consumption
- Less maintenance - no lubrication required
- No down-drift of the load even when the air is shut off
- Snap-back prevention
- Optional Hoist Module: ABC-5G-B grip style or ABC-5P-B pendant style
- Dimensions: 9.92" x 18.35" (252 mm x 466 mm)

Order Balancer Body and Hoist Control Module separately. For optional balancer body connection methods, see bottom of Page 18.

Balancer Body

Part No.	Air Pressure		Max. Lifting Capacity		Air Inlet	Stroke		Weight	
	PSI	(MPa)	lbs	(kg)		ft	(m)	lbs	(kg)
EHB-50	43.5	(0.3)	44.1	(20.0)	Rc 3/8	6.2	(1.9)	86.0	(39)
	58.0	(0.4)	66.1	(30.0)	Rc 3/8	6.2	(1.9)	86.0	(39)
	72.5	(0.5)	88.2	(40.0)	Rc 3/8	6.2	(1.9)	86.0	(39)
EHB-85	43.5	(0.3)	66.1	(30.0)	Rc 3/8	6.2	(1.9)	88.2	(40)
	58.0	(0.4)	99.2	(45.0)	Rc 3/8	6.2	(1.9)	88.2	(40)
	72.5	(0.5)	132.3	(60.0)	Rc 3/8	6.2	(1.9)	88.2	(40)
EHB-130	43.5	(0.3)	88.2	(40.0)	Rc 3/8	6.2	(1.9)	103.6	(47)
	58.0	(0.4)	137.8	(62.5)	Rc 3/8	6.2	(1.9)	103.6	(47)
	72.5	(0.5)	187.4	(85.0)	Rc 3/8	6.2	(1.9)	103.6	(47)

Accessories

Hoist Modules

ENDO's complete line of hoisting modules allows you to use your ENDO air hoist with the ease and precision you need. From simple push button pendants, to grip style control. See the chart below to find the right one for your model.



MS/MSS



MS-A



MS-AG



ABC-5P-B



ABC-5G-B

Hoist Module Model	Operation Style	For Models	Unit Weight	
			lbs	(kg)
MS	Pendant	EHB 50S(C), 50(C), 85(C), 130(C), 270CR	4.4	(2.0)
MSS	Pendant	EHB-270(C), 450CR	4.85	(2.2)
MS-A	Pendant	All Models	7.7	(3.5)
MS-AG	Grip	EHB-50S(C), 50(C), 85(C), 130(C), 270(C)	11.0	(5.0)
ABC-5P-B (Auto)	Pendant	EHB-50S(C), 50(C), 85(C), 130(C), 270CR	24.25	(11.0)
ABC-5G-B (Auto)	Grip	EHB-50S(C), 50(C), 85(C), 130(C)	24.25	(11.0)

Options

Order one or the other separately, if the standard hard-mounted bracket wont fit the application.



Trolley



Hook Set

Option	Part No.	Hoist Model
Trolley (for 75mm, 100 mm widths)	LHP001899	-
Upper Hook Set	LHP001900	MS, MS-A, MS-AG
Upper Hook Set	LHP001991	MSD, ABC

Other Products from Conductix-Wampfler

The products described in this catalog represent a few of the products from the broad spectrum of Conductix-Wampfler components and systems for the transfer of energy, data, gases, and fluids. The solutions we deliver for your applications are based on your specific requirements. In many cases, a combination of several different Conductix-Wampfler products are needed to fill the application. You can count on all of Conductix-Wampfler's business units for hands-on engineering support - coupled with the perfect solution to meet your energy management and control needs.



Motor driven cable reels

Motor driven reels by Conductix-Wampfler are the perfect solution for managing long lengths of heavy cable and hoses in very demanding industrial applications. Monospiral, level wind, and random wind spools.

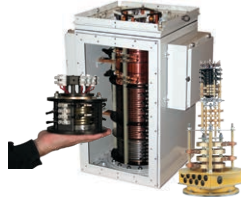

Slip ring assemblies

Whenever powered machinery needs to rotate 360°, field proven slip ring assemblies by Conductix-Wampfler can flawlessly transfer energy and data. Here, everything revolves around flexibility and reliability.



Conductor bar

Whether they are enclosed conductor rails, expandable single-pole bar systems, or high amperage bar for demanding steel mill use up to 6000 amps. Conductix-Wampfler's conductor bar is the proven solution to reliably move people and material.



Spring driven cable reels

We have 60 years experience and trusted brands such as Insul-8, Wampfler, and IER. We offer small cord reels all the way to large multi-motor units, a wide range of accessories, and hazardous location reels.



Cable Festoon systems

It's hard to imagine Conductix-Wampfler cable trolleys not being used in virtually every industrial application. They are reliable and robust and available in an enormous variety of sizes and models.



Push Button Pendants

Our ergonomic pendants are ideally suited for industrial control applications. They are available in a wide range of configurations for overhead cranes and other machinery.



Radio remote controls

Safe, secure, and reliable radios use the latest in microprocessor technology. Available in several models for overhead crane control and other types of machinery.



Inductive Power Transfer IPT®

The contact-less system for transferring energy and data. For all tasks that depend on high speeds and absolute resistance to wear.



Data Transfer: ProfiDAT® | Nexus

Safe & reliable wireless communication using slotted waveguide technology that's PROFSafe compatible.

Nexus NB for narrow band signal transfer over power conductors



LJU Automation EMS Controller

Specialized controllers Programmable by parameters, Ideal for Electrified Monorails at automotive plants, with over 1500 in service worldwide. Adaptable for other applications



BridgeGuard™

Prevents crane to crane and crane to end collisions. IP69K rated for indoor and outdoor use, with a 3 ft to 150 ft range. Compliant with IEC 60068-2-6:2007



Air & Spring balancers | Air hoists

Conductix-Wampfler offers the full line of ENDO positioning devices. Rugged, reliable steel construction increasing safety and decreasing fatigue and body stress.

www.conductix.us

USA / LATIN AMERICA

10102 F Street
Omaha, NE 68127

Customer Support
Phone +1-800-521-4888

Phone +1-402-339-9300
Fax +1-402-339-9627

info.us@conductix.com
latinamerica@conductix.com

CANADA

1435 Norjohn Court
Unit 5
Burlington, ON L7L 0E6

Customer Support
Phone +1-800-667-2487

Phone +1-450-565-9900
Fax +1-450-951-8591

info.ca@conductix.com

MÉXICO

Calle Treviño 983-C
Zona Centro
Apodaca, NL México 66600

Customer Support
Phone (+52 81) 1090 9519
(+52 81) 1090 9025
(+52 81) 1090 9013

Fax (+52 81) 1090 9014

info.mx@conductix.com

BRAZIL

Rua Luiz Pionti, 110
Vila Progresso
Itu, São Paulo, Brasil
CEP: 13313-534

Customer Support
Phone (+55 11) 4813 7330

Fax (+55 11) 4813 7357

info.br@conductix.com

Contact us for our Global Sales Offices

